



# Q.C.C. Wanderer

'Fellowship on Wheels'



September/October 2020 Edition



Then official newsletter of the Queensland Caravan Club Inc

# Q.C.C. Wanderer

## 'Fellowship on Wheels'

Email: editor@qldcaravanclub.com.au

Issue: 09/2020

QCC - Established 1949

September/October 2020

### **President's Report - Sep/Oct 2020 ....**

Well, what a top rally we had working under the clubs own approved COVID - 19 safety plan which we are now able to use for future rallies. A big thank you to all members for abiding by the rules such as sanitising hands and social and physical distancing. It is important we keep doing this until the rules change.

**Wednesday 09 Sep.** Di and I arrived early after camping the previous night at Heifer creek.

Secretary Heather and I went to the Toowoomba Council to submit our COVID plan and to collect the forms and rules they required us to have, paid for the rally and collected the keys. This enabled Dennis Edney to unlock the showground power boxes and set-up where to park everyone.

We had 22 vans arrive, and later that evening, about 30 people headed to the pub for dinner where I had the best steak ever.

**Thursday.** The weather was windy and a bit cool, but despite this, a large group of walkers set-off early. Six ladies went for a game of golf and another on Friday, so the ladies golf group is growing which is pleasing to see.

With a team of helpers, we set-up the hall, put-up the COVID signs, set-up sanitising stations, organised cleaning teams for the toilets all to comply with the COVID rules. Many members went out for dinner that evening at different restaurants around town.

**Friday.** The walkers were out again early. They were keen as it was very cool. 16 gents went to play golf, some better than others (I was in the other category! 😊). We had the Management Committee Meeting and I thank the team for their efforts, commitment and input; the club cannot run without them. There was large group of ladies at the sewing class (gents are allowed and welcome) led by Yvonne Robbins.

Bowls attracted 22 members which is growing every rally (ladies are welcome). As always, happy hour is always enjoyable. We need to be mindful of social distancing at all times. Cards were played in the hall that evening.

**Saturday.** The wind had dropped and it was a very pleasant day. The walkers were out again, we had morning tea and the general meeting followed by the annual general meeting. Thanks to John Carroll

for chairing the AGM and for running the election which he did quite professionally.

Unfortunately, nobody put their hand up for the president's job, so sorry members, you have got me a bit longer 😊.

We welcomed incoming committee members Kerry Hogan and Jenni McGowan and thanked outgoing members George Lacey, Barry Gibson and Jeff Cochrane for all their help on the committee.

Well, we finally got to have the President's Picnic thanks to little 'First Lady' Di and a very large team of helpers who worked very hard putting it all together. There were beef pies, mashed spuds, peas and gravy followed by dessert. The event was held in the open and we did end up in the dark but it was very enjoyable.

Afterwards we gathered in the hall for a quiz show 'Celebrity Heads Covid-Style' and many thanks to Kevin and Carol Day for putting it all together and running it. I loved the pictures of the Brisbane trams.

**Sunday.** After paying the treasurer we all gathered for the cutting of the club's 71<sup>th</sup> anniversary birthday cake and sung happy birthday to our wonderful club. The cake, organised by Merv Kahler, was cut collectively by life members Barbara and Bob Rutherford, Jacky and Tom Smith, and Yvonne and Bert Beker. Following this, we adjourned to our Sunday meeting. Thank you, Merv, for organising the cake .... beautiful!

I considered the Pittsworth rally to be an excellent rally, but not quite back to normal because of COVID-19, but we must follow the rules that are in place. They will get better as restrictions ease.

A special thanks to all the members who helped the club at Pittsworth. With so much on and so much to do, it could not have been achieved without you. I was very proud, overwhelmed and most grateful with so many helpers and for the work done. Thank you to everyone.

So until the next rally at Nanango, safe travels, stay healthy, look after each other.

*President Paul ....*



**Next Rally ~ Nanango 07-13 October.** Members are asked to arrive no earlier than midday Wednesday 7<sup>th</sup> October and depart no later than midday 13<sup>th</sup> October.

**From Brisbane:** From Brisbane: Follow the Ipswich Motorway, then, at Riverview, exit left onto the Warrego Highway (A2) towards Toowoomba. At approximately 15 kilometres, take the Brisbane Valley Highway exit and follow through to the D'Aguilar Highway. Follow the D'Aguilar Highway through to Nanango.

**From the north:** Follow the D'Aguilar Highway through Nanango.

**From the west:** Take the New England Highway to Yarraman and turn left onto the D'Aguilar Highway to Nanango.

On entering Nanango, turn left at the lights (D'Aguilar Highway), and at 650 metres, turn left into Cairns Street (fourth street from the lights). The showground entrance is at 200 metres on the right.



**Nearest Hospital:** Nanango Hospital, 135 Brisbane Street, Nanango, 4615. Phone: 07 4171 6700. 24 hours.

**Nearest Doctor / Medical Centre:** Drayton Street Family Practice, 85 Drayton Street, Nanango, 4615. Phone: 07 4171 0711.

Monday-Friday from 8:00am-5:00pm. Saturday 8:00am-12 Midday. Sunday closed. (present to the Nanango Hospital if urgent medical attention needed or dial 000).



**Rally Venue Address:** Cairns Street, Nanango. 4615.

**Nearest Cross-Street:** Cairns Street and the D'Aguilar Highway.

**Post Code:** 4615.

Club equipment required:	First aid kit, fire extinguisher, banner, flags and flagpoles.						
GPS Coordinates:	<b>DUMP POINT.</b> On site. Those with a medical need who require to be sited close to the amenities are to contact rally marshal, Dennis Edney, on 0411 539 494 by the Monday prior to the rally otherwise this area may not be available. <u>Arriving late or cannot attend!</u> Please let the rally marshal know. <b><u>Please do not drive over power leads or hoses.</u></b>						
Lat: 26°67'19.58"S Long: 151°99'30.61"E							
Pets:	Permitted. Dogs/cats must be on a leash. Please pick-up after your pet.						
Fees:	<table border="0"> <tr> <td>Site:</td> <td>\$9.00 per person per night (powered). \$7.00 per person per night (unpowered).</td> </tr> <tr> <td>Administration:</td> <td>\$3.00 per van/motorhome.</td> </tr> <tr> <td>Hall:</td> <td>\$3.00 per van/motorhome.</td> </tr> </table>	Site:	\$9.00 per person per night (powered). \$7.00 per person per night (unpowered).	Administration:	\$3.00 per van/motorhome.	Hall:	\$3.00 per van/motorhome.
Site:	\$9.00 per person per night (powered). \$7.00 per person per night (unpowered).						
Administration:	\$3.00 per van/motorhome.						
Hall:	\$3.00 per van/motorhome.						



**NANANGO** Nanango is situated 190 kilometres north-west of Brisbane and sits at the junction of the D'Aguilar and Burnett Highways.

The original inhabitants of the area were Aboriginals belonging to the Wakka Wakka (or Waka Waka) people. The area was used as a gateway to the bunya nut festivals, where Aboriginal people would travel from as far away as the Clarence River in northern New South Wales and the Maranoa River to feast on bunya nuts from the bunya trees.

The area around Nanango was first settled by Europeans in 1847. The first commercial establishment at the present site of Nanango was Goode's Inn, founded by prospector Jacob Goode in July 1848. The inn served travellers journeying from Brisbane and Limestone (now Ipswich) and became the meeting place for early residents of Taromeo, Tarong and Nanango stations.

Nanango claims to be the fourth oldest town in Queensland. The name 'Nanango' evolved from the Wakka Wakka word 'Nunangi'. There is dispute over the origins of the name Nanango - the word



means 'large watering hole' or was also the name of a local Aboriginal elder at the time of settlement. The original settlement was called 'Noogoonida' by the Aboriginals, meaning 'place where the waters gather together'.

Beef, dairy and timber (in particular the valuable red cedar) were the primary early industries in the area. The discovery of gold at the Seven Mile Diggings near Nanango in 1867 precipitated a gold rush, and consequently a local population boom, however the gold deposits were found to be meagre. At one time the population included 700 miners, many of whom were Chinese.

A second population boom occurred when the Brisbane Valley railway line was extended to Yarraman in 1911. Nanango became the terminus of a branch-off the South Burnett railway line at Kingaroy on 13 November 1911. The 22.5 kilometres missing rail link between Nanango and Yarraman, although planned was never built.

After World War I, however, growth levelled-off until the early 1970s when the development of the Tarong Power Station led to a third population explosion. McCauley Weir was used as the town's water supply until three additional bores were drilled at the confluence of Barkers Creek and Meandu Creek.

Today, Nanango's principal industries are power generation, coal mining, agriculture, beef and pork production, dairying and milk processing, timber growing and milling, small crops, natural medicine, art and craftwork and tourism.

Also on the D'Aguilar Highway are the Tipperary Flat pioneering displays that paint a vivid picture of life as it used to be. You can also visit nearby Ringsfield House; a large, grand turn-of-the-century Queenslander designed by famed architect Robin Dods and faithfully restored and furnished to reflect its diverse history. Tour the house and stay for morning or afternoon tea or a tasty lunch on the veranda overlooking the gardens.

Get into the country spirit at the local horse races – Lee Park Racetrack hosts six meetings a year. For racing of a more hair-raising nature, the South Burnett Go-Kart track is also close by.

Other annual events where you can soak up the country vibe include the Nanango Show in April, Heritage Nanango Country Music Muster in September and Waterhole Rocks in October.

If you love a country market, Nanango has one of the biggest in South East Queensland. Held on the first Saturday of each month at the Nanango Showgrounds you'll find something for everyone.

In the 2016 census, Nanango had a population of 3,599 people.

Highly recommended is a visit to the South Burnett Visitor Information Centre, located at 41 Henry Street, Nanango. Closes at 4:00pm. You won't be disappointed.



**CAPALABA CARAVAN REPAIRS**  
**GAMPER TRAILER HIRE**

*Cam*

**PHONE: (07) 3823 2322**  
**FAX: (07) 3823 5957**  
**Unit 2, 9 India Street Capalaba Q 4157**  
**Email: [info@capalabacaravanrepairs.com.au](mailto:info@capalabacaravanrepairs.com.au)**  
**[WWW.CAPALABACARAVANREPAIRS.COM.AU](http://WWW.CAPALABACARAVANREPAIRS.COM.AU)**

 **Happy Birthday to You for October 2020** 

03 Pat Gower  
05 Kerry Hogan  
08 George Lacey  
12 Brenda Usher  
15 Mavis Martin  
16 Barry Gibson



18 Stewart Hornibrook  
19 Dell Lowe  
19 Richard Van Wyk  
19 Barbara Cook  
20 Ron Robson-Petch  
21 David Judge



22 Dell Gray  
26 Mel Dale  
28 Paul Brearley  
28 Roger Adams  
31 Dennis Edney



 **Happy Anniversary to You for October 2020** 

05 Gail and Adrian Skinner  
05 Gloria and Ian Bamberry  
10 Barbara and Bob Rutherford  
10 Jill and Eugene Boyle  
12 Dianne and Kerry Hogan  
19 Carmel and Roy Bridges



21 Jacky and Tom Smith  
23 Lyn and Roy Hill  
28 Pam and Ray MacDonald  
28 Yvonne and George Lacey  
28 Jean and Mel Dale  
31 Vicki and Wayne Hills



**55 Vans @ Pittsworth ....**

- **ABRAHAM**, Beris and Carmel.
- **ADAMS**, John and **FLEWELL-SMITH**, Lynda (second time).
- **BARR**, Graham and Pat.
- **BECKER**, Bert and Yvonne.
- **BELL**, Fay and Greg (first time).
- **BREARLEY**, Paul and Di.
- **BRIESE**, Tina (first time).
- **BURDETT**, Ivan and Robyn.
- **CADDIES**, Ray and Gail.
- **CARROLL**, John and Jenny.
- **COCHRANE**, Jeff and Jean.
- **COXALL**, Terry and **COOK**, Gabby.
- **DAY**, Kevin and Carol.
- **DOBE**, Bill and Ann.
- **DROUGHT**, Michael and **REEDY**, Linda.
- **EDNEY**, Dennis and Heather.
- **EGEN**, Ian and Gwen.
- **FITZGIBBON**, Colin.
- **GIBSON**, Barry and Wendy.
- **GRAHAM**, Shane and Judith.
- **HASLEWOOD**, Lance and Karen.
- **HENRY**, Rick and Cheryl.
- **HILLER**, Margaret and **STEGEMAN**, Rod.
- **HINSON**, Alf and Desley.
- **HOGAN**, Kerry and Dianne.
- **HOLMES**, Elizabeth (first time).
- **HOLT**, Jim and Minnie.
- **ISON**, Gordon.

- **JAMES**, Colin and Margaret.
- **JUDGE**, David and Helen.
- **KAHLER**, Merv and Carolyn.
- **KAYS**, Darryl.
- **KEARNEY**, Bob and Kathy.
- **LACEY**, George and Yvonne.
- **LANDER**, Barry and Gail.
- **LANGLEY**, Steve and Robyn.
- **LOWE**, Phil and Del.
- **MACDONALD**, Ray and Pam.
- **MANDER**, Greg and Pat.
- **McCALLUM**, Keith and Bev.
- **McGOWAN**, Murray and Jenni.
- **MIERS**, John and Jan.
- **NOFFKE**, Owen and **KIRBY**, Jan.
- **PARK**, Terry and Denise.
- **RIDER**, John.
- **ROBBINS**, Yvonne.
- **RUTHERFORD**, Bob and Barbara.
- **SAVAGE**, Adrian and Ann.
- **SMITH**, Tom and Jacky.
- **STEPHENSON**, Tony and Sue.
- **TEBBIT**, Bob and Marilyn.
- **THORPE**, Jim and Sue.
- **VAN WYK**, Richard and Linda.
- **VERSACE**, Peter and **FERREIRA**, Deb (first time).
- **WAYCOTT**, Bill and Denise.



**The Club welcomed the following @ Pittsworth:**

**First-Time Visitors** - Fay and Greg **BELL**, Tina **BRIESE**, Elizabeth **HOLMES** and Deb **FERREIRA**.

**Second-Time Visitors** - John **ADAMS** and Lynda **FLEWELL-SMITH**.

**Day Visitors** - Roger and Laurel **ADAMS**, Ian and Denise **FARRELL**, Rodney and Mary **METCALFE**, and Les and Brenda **USHER**.



**Rally Programme for Nanango ...**

Thursday 10 Sep	6:30am 1:00pm 6:30pm	Walkers. Card Making (Bev Green). Pub Dinner (own arrangements).	
Friday 11 Sep	6:30am 7:00am 9:00am 11:00am 1:00pm 2:30pm 4:00pm 6:30pm 7:30pm	Walkers. Golf. Sewing Class - fabric preparation & pre-cut. Management Committee Meeting. Sewing Class (Yvonne Robbins). Bowls. (please register). Happy Hour. Pub Dinner (own arrangements). Cards.	
Saturday 12 Sep	6:30am 8:00am 9:00am 9:30am 11:00am 1:00pm 4:00pm 7:00pm	Walkers. Tai Chi (Lyn Hill). Morning Tea. General Meeting. Singles Disc Bowls (registrations close). Singles Disc Bowls (Barry and Wendy Gibson). Happy Hour. Letterbox (Tom & Jacky Smith). Social Distancing.	
Sunday 13 Sep	6:30am 8:00am 8:30am 9:30am 2:00pm 4:00pm 6:00pm	Walkers. Tai Chi (Lyn Hill). Pay Treasurer. Meeting. Nana-Nap. Happy hour. Dinner (own arrangements).	

**IMPORTANT**

- \* Remember to check the rally noticeboard for any last minute changes to the published programme.
- \* Remember to sign the attendance book as soon as possible after arrival.
- \* Remember to indicate your planned attendance to the next rally by checking (ticking) the rally attendance sheet located at the Saturday/Sunday meeting.
- \* Kindly give a hand to stack the chairs and to sweep the hall following the Sunday meeting. Many hands make light work.

- \* Have a UHF radio? If so, please give an inbound call (Ch 18) to the rally marshals so that your site placement may be both speedy, fluid and hassle-free.
- \* Enjoy your time at Nanango, join-in and participate. There is a lot to see and do in the area. **Be sure to visit the South Burnett Visitor Information Centre, 41 Henry Street, Nanango.**

**IMPORTANT: Anticipating attending Friday bowls? Please add your name to the register located in the hall.**

**2020 QCC Open Singles Disc Bowls Competition – Saturday at Nanango**

With COVID-19 hanging around trying to spoil our fun, be assured that we'll be doing our level best to keep you safe.

It's a singles comp – both ladies and gents are welcome. If you've not played before, still join in – someone will show you the ropes – beginners have done well in the past. Will a lady win the comp this year? Ladies have reached the finals and semis, but so far have not won ... maybe this year.

But if you don't wish to play, we love to see lots of spectators (just bring your chair).

To play, please place your nomination in the box (in the hall).

- The times to remember on Saturday are:
- Nominations to play close at 11:00am.
  - Games will be posted on the Noticeboard by noon.
  - Games commence at 1:00pm sharp.

Please note – if you are unable put your name in the nomination box by 11:00am, please advise Wendy Gibson beforehand and she will be happy to add your name to the list.

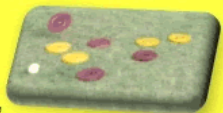

**Your help as Marker will be very much appreciated.**

If attending disc bowls, it is suggested you bring your own shade cover and chair.

Similarly, and most importantly, don't forget your sun block.

**COVID FUNNIES**



1. My husband purchased a world map and then gave me a dart and said, "Throw this and wherever it lands, that's where I'm taking you when this pandemic ends." Turns out, we're spending two weeks behind the fridge!
2. Ran out of toilet paper and started using lettuce leaves. Today was just the tip of the iceberg; tomorrow remains to be seen.

### Member Profile ~ Life and Times of Sue and Jim Thorpe ....

In 1951, my parents moved from Melbourne where I was born in 1949 (yes, another 49er in the club) to the village of Buninyong (10 km south of Ballarat), and Sue's parents moved from Geelong (where Sue was born in 1950) to Ballarat. We blame these moves so early in our lives for creating our strong 'Gypsy' streak.

Sue and I met in 1968, and married in 1971. During our marriage we have lived in four states (two twice) and have moved house twenty times. Until we retired, all our moves were work-related. It may surprise some people that we met at a dance in the Civic Hall in Ballarat. With time off to raise our three children, dancing has remained a passion for us both to this day.



Our children, Bernard, Jennifer and Steven between them, have presented us with eight grandchildren with ages ranging from six to twenty. Bernie lives in Brisbane, Jenni in San Francisco and Steve in Perth. Their distribution around the globe contributes to our regular interstate and overseas travel. We try and visit our remote families at least twice a year.

When Sue and I met, I was an apprentice bricklayer (with a burning ambition to be a technical school principal), and Sue had been accepted and was about to march into the Australian Army as a WRAAC. Consequently we courted through the medium of letters and telephone, and when possible getting together wherever we could.

I was fortunate in achieving my work ambition in 1987 when I was appointed Director, Central Highlands College of TAFE Emerald, Queensland. I had attended a technical college in Ballarat for my secondary education, a technical college in Melbourne for my apprenticeship training, and another technical college in Ballarat for building technician training at night. In 1973, I was appointed as a technical teacher at Eagle Farm College, Whinstanes Queensland. Subsequently, I worked there, followed by time at Bald Hills TAFE, South Brisbane TAFE, Technical Correspondence School, Toowoomba TAFE, North Point Institute and Mt Isa TAFE, prior to promotion to Director Emerald TAFE. From when I left Primary school, I spent my life either as a student, teacher or educational administrator at a Technical or TAFE College.

While working full time as a teacher and in more senior roles, I continued to study part-time eventually achieving a number of higher educational qualifications. I was aware that in order to be promoted further, both extensive experience and higher qualifications would be required. None of my achievements would have been possible without the full support and encouragement of Sue.

Shortly after gaining the Director's position at Emerald, all such roles were made contract positions. I had to reapply and was reappointed under the new conditions to a five year contract which I served out. I had always imagined I would retire from TAFE Queensland at 65 years of age, but as a contract

employee, the nexus was broken, and in due course, I cast my eye wider. Subsequently, I served contracts in senior roles in Western Australia for the state government, in Victoria for the University of Ballarat, and New South Wales for the State government retiring as Institute Director, TAFE New South Wales Western Institute. All my senior roles were regionally-based. As an example, in my last job, I was based in Orange and had twenty four TAFE colleges from Lithgow to Broken Hill reporting.

Sue resigned from the army upon marriage. We built a new home on a hill in Ballarat East and started our family straight away. We decided that the best way to raise a family would be for Sue to be a full time mum. At this she was very successful raising three children through to university education, on to successful careers and subsequent marriage and family responsibilities. As well, Sue also fully supported me in my various work and other roles and in my endeavours for self improvement and advancement. Once our 'nest' emptied, Sue rejoined the outside workforce working in the Town Library (Port Hedland), and aged care (Orange).

While working full-time and studying part-time, I enjoyed fifteen years CMF/Army Reserve service. When I first volunteered after missing-out on national service, Sue outranked me. Subsequently, I served in infantry units in Victoria and Queensland. I also spent a number of years in various postings in the Corp of Transport specialising in road transport (trucks) and movement control. For twelve of my

fifteen years service, I was a commissioned officer. It was with great reluctance, I resigned from the Active Reserve, a part-time role, to focus more fully on family and my full time career.

Twelve months before we retired we upgraded our tent to a camper trailer. However, we found it very difficult to get away on weekends to use it while working. My office in Orange overlooked the main intersection in town, and I found myself watching caravans drive past wishing I was with them. Decision time! Time to retire. We did this in mid-2006 and returned to Queensland and Brisbane.

Not long after returning to Brisbane, we joined the South East Caravan Club to join like-minded people in our new recreational activity of caravanning. Over the next ten years, we attended many monthly rallies and several state rallies all of which we enjoyed. In 2018, we joined QCC, as by this time, we knew many of the club's friendly members and the clubs more flexible attendance requirements better met our needs. We have not been disappointed and have found everyone to be so welcoming and inclusive. Since retirement, we estimate we have travelled over 140,000 kilometres towing either our camper or our caravan around Australia. It has been a wonderful experience

enjoying the 'freedom of the road'.

In addition to extensive travel throughout Australia during our retirement, we have been fortunate to have travelled the wider world regularly, clocking-up forty-three trips and visiting eighty-six countries to date. Cruising by ship has also been a big part of our overseas travel with over four hundred sea nights on thirty-six cruises with a number of different cruise lines. If not for COVID-19 restrictions, we would have added another sixty three nights to our tally.

Three years ago we moved into Living Gems Riverside in Caboolture South, a resort for active over 50's. Living here we are able to engage in all the interests we already had plus some new ones. These include lawn bowls, swimming, walking, cycling, kayaking, ten-pin bowls, tennis, and card and board games.

We both still maintain outside activities such as social ballroom dancing. I play lawn bowls socially at a local club and Sue enjoys her book club.

Caravanning through QCC is also an important outside activity we hope to maintain for many years to come.

Jim and Sue Thorpe.



### QUEENSLAND CARAVAN CLUB COMMITTEE 2020-2021

L-R: Barbara Rutherford, Merv Kahler, Carol Day, Heather Edney, Kerry Hogan, Paul Brearley, Ray and Gail Caddies, Lance Haslewood, Richard Van Wyk, Jenni McGowan and Roger Adams.

**Cover Photographs:** (Top) Life members collectively cutting the QCC 71<sup>st</sup> Anniversary Cake with President Paul Brearley. L-R: Bert and Yvonne Beker, Bob and Barbara Rutherford and Tom and Jacky Smith. (Bottom) Bert Beker serves Laurel Adams, Owen Noffke, Graham Barr and Roger Adams.





# Sunshine Column

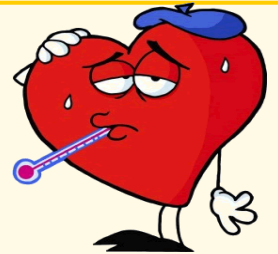

To those who have endured the loss of a dear one, ill health, hospitalisation, surgery or misfortune; the very best wishes to you all. We are thinking of you.

Sylvia Stocker, Denise Waycott, Merv Kahler, Trevor Martin & Lynda Van Wyk.

Sincere apologies if we have missed anyone.

## Pittsworth Golf:

17 gents and 6 ladies attended.

Ladies:

- 1<sup>st</sup> Deb Ferreira, 52.5.
- 2<sup>nd</sup> Di Brearley, 56.25.
- 3<sup>rd</sup> Denise Park, 58.25

Gents:

- 1<sup>st</sup> Alf Hinson, 34.75.
- 2<sup>nd</sup> John Rider, 38.5.
- 3<sup>rd</sup> Dennis Edney, 39.00.

Longest Drive - Alf Hinson.  
Nearest to the Pin - Terry Park.



## Spending @ Pittsworth:

Total: \$11,045.00.



- \$50.00 Lucky Number ~ Emily Egen.
- 1<sup>st</sup> \$50.00 Gift Card ~ Jan Kirby. Donated by QCC.
- 2<sup>nd</sup> (Bag) ~ Denise Waycott. Donated by Jenny Carroll.
- 3<sup>rd</sup> (Wooden Solitaire) ~ Ian Farrell. Donated by Doug and Dorcas Burt.



## Lucky Van Draw Winners ...

- Ray and Pam MacDonald.
- Terry and Denise Park.



Phone 3425 2420

# Caravan Refrigeration Service

M - 0407 670 534  
E - info@caravanrefrigerationservice.com.au  
www.caravanrefrigerationservice.com.au

## B&B CARAVAN SERVICE & REPAIRS

Call us today to find out more  
3881 3884 | 0408 870 751

Over 31 Years Experience

Family owned and operated

AUTHORISED WARRANTY AGENT  
JAYCO - NEW AGE - THETFORD - DOMETIC -  
ALKO - COAST TO COAST WARRANTY

No Job is too Small Or to Big  
Member CTIA

Unit 5/36 Deakin street, Brendale QLD 4500



# CRUISEMASTER™

AUSTRALIA'S LEADER IN ALL-TERRAIN TOWING TECHNOLOGY

## ATX XT CRS GT

SUSPENSION SYSTEMS

## FO DO35 DO45

COUPLINGS

CRUISEMASTER.COM.AU 07 3624 3800  
FACEBOOK/INSTAGRAM @CRUISEMASTERCOUNTRY

FOR THE VAN  
PRE-TRIP INSPECTIONS  
SUSPENSION RETROFITS & SERVICING  
WHEEL ALIGNMENTS

FOR THE 4X4  
UPGRADES FROM REDARC, AIRBAG MAN,  
FLASH DIESEL, PEDDERS, ARB, TJM

# CRUISE MASTER TPC

TOWING PERFORMANCE CENTRE

LOCATED IN GEEBUNG QLD E: TPC@CRUISEMASTER.COM.AU

## 'Nanango Sewing Project with Yvonne Robbins'

### 'CHRISTMAS TABLE RUNNER'



#### Material and Cuts

- 1 metre of plain fabric.
- 1 meter of light coloured printed fabric.
- 1 meter of dark printed fabric.
- Cottons to match.
- ¼ inch machine foot.
- Pencil or marking pen, scissors, iron and board.
- Large towel to lay blocks on.

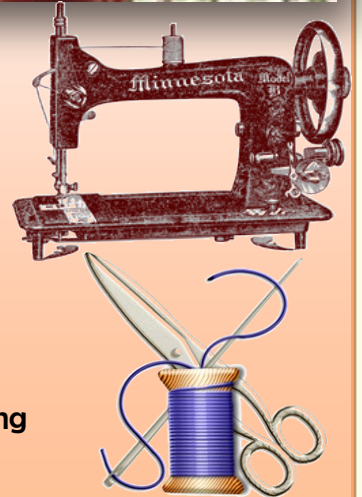

Ladies are welcome to cut their blocks from 9:00am on Friday. Sewing will commence at 1:00pm.



## COVID REQUIREMENTS QUEENSLAND CARAVAN CLUB INC Nanango Rally

To assist our efforts to prevent the spread of COVID-19, we ask of the following:

- Feeling unwell or have cold or flu-like symptoms? Please do not attend the rally.
- Please complete the QCC COVID Declaration Form and hand to the Club's COVID Officer upon arrival at the rally site. The form is included in this newsletter or may be downloaded from the QCC website.
- Members are asked to provide their own masks.
- Please remember to social and physical distance at all times.
- Please cleanse your hands regularly with the sanitiser provided.
- Please minimise what you touch.
- Line-ups or groups congregating around the morning tea area to collect requisites for tea or coffee is be strictly avoided.



#### For the Interest of Members

Advising that due circumstances associated with COVID-19, the committee has decided, that, in the best interest to members, there will be only DVDs and library books available at the Nanango rally.





## IS YOUR CARAVAN'S COMPLIANCE PLATE LYING TO YOU?

The trailer plate, often misleadingly referred to as the compliance plate, is an important part of a caravan or camper-trailer, but is your compliance plate lying to you?

The intent of fastening trailer plate to a vehicle is to provide assurance from the manufacturer - to vehicle registration authorities and the purchaser - that the vehicle is fully compliant with all prescribed legislation and as such it is ready for use on Australian roads. Sadly, for far too many caravans, this is clearly not the case.

Vehicle Safety Standards has stated that all information provided on a trailer plate must be:

- Legible.
- True.
- Correct.
- Accurate.
- Complete.



Actual Masses such as Tare Mass and Empty Ball Loading must be physically measured, by scales or on a weighbridge that is certified and has been independently checked for accuracy, as prescribed in the licencing contract. The Tare Mass and Empty Ball Loading measurements must be made when the caravan (including water tanks and gas cylinders) is completely empty, and fitted with all equipment that is specified on the sales contract.

The legal significance of an assurance needs to be clearly understood. Negligence, ignorance and assumption are not defences for stating any information that is not in strict accordance with the requirements. Needless to say, stating any information that is fraudulent is a very grave matter.

The trailer plate must show at least the following information:

- Manufacturer's name.
- Caravan model.
- Vehicle Identification Number (17-digit).
- Date of manufacture (month/year, e.g., 08/20).
- Aggregate Trailer Mass (ATM) rating.
- Certification Statement: 'This trailer was manufactured to comply with the Motor Vehicle Standards Act 1989'.



Old school compliance

The trailer plate may also include additional information, such as that required for the tyre placard. Masses and Ratings must be stated in kilograms (kg). Tyre inflation pressures must be stated in kPa (not psi).

The full specifications of the wheels (diameter, width and profile) and tyres (diameter, section ratio, width, and type [P/C/LT]) must be stated so that there is no guessing required to determine the complete specifications.

In addition to the information that is required by VSB1 (Vehicle Standards Bulletin No.1), it is most prudent to advise additional information that may very well be deemed to be "information required by the owner/driver, so as to best ensure that the tow vehicle and caravan are loaded and used in a safe and legal manner".

This information includes the:

- Gross Trailer Mass (GTM) Rating.
- Axle-Group Rating.
- Empty Ball Loading.

The Gross Trailer Mass (GTM) Rating is needed to confirm what braking system is required... is it above or below 2000kg?

The Axle Group Rating and the Gross Trailer Mass (GTM) ratings are needed - for non-load-sharing suspension systems - to confirm if the 120% safety factor has been incorporated in the design of the suspension system.



The Empty Ball Loading is needed to ensure that the caravan is suitable for the intended tow-vehicle. It will also assist in correctly loading the caravan so that load-distribution (in a side view) does not cause any rating to be exceeded, or the caravan to develop hazardous handling and stability problems on the road.

It is recommended that the offset - plus or minus 'X' mm - of the wheels be added so that if aftermarket wheels are fitted, the same offset can be selected, so as to avoid having the tyre's sidewalls foul on any chassis or body component, which can readily cause dangerous blowouts.

It is important to know that the allocated GTM Rating has been properly determined by the manufacturer.

Unfortunately, many people continue to use the incorrect 'old husbands tale' or either of these two equations:

- Empty Ball Loading = ATM Rating - GTM, or
- GTM Rating = ATM Rating - Empty Ball Loading.

This is completely wrong because there is no logical relationship involved!

The ATM and GTM are fixed ratings allocated by the manufacturer, in relation to the maximum-permissible all-up and Axle(s) limits.

The Empty Ball Loading is an actual mass that must be measured and is obviously applicable only to the empty (Tare Mass) condition.

The correct formula is, at any time:

- Actual Ball Loading = All-up Mass - Axle(s)-Loading.

It is essential that all caravan buyers fully understand all of the information that is provided by the manufacturer on the trailer plate, before they accept the caravan, in order to avoid possible major problems in the future. You should obtain a copy of the certified measurements of the Tare Mass and the Empty Ball Loading.

If you have any questions about any items on the trailer or compliance plate, it is important to have the dealer provide a concise and credible explanation. That way, if your compliance plate is lying to you, you have the opportunity to sort it out there and then. Not later. And not in court.

Thanks to Colin Young of the Caravan Council.



QCC is seeking crocheted Remembrance Poppies for its Goombungee rally in November. The poppies will be used to form a wreath for laying at the Goombungee War Memorial at the Remembrance Day Service. If you have a talent for crocheting, and you have some spare time to make a poppy or two, it would be most appreciated. Please bring them to the Nanango rally.



**MACH 1**  
Caravan & RV Solutions

ABN 52 134 287 712

- Service
- Repairs
- Insurance Repairs
- Solar Packages
- Modifications

**Philip Hooper**

Unit 4, 10 Boeing Place  
Caboolture, 4510

[www.mach1caravanrepairs.com.au](http://www.mach1caravanrepairs.com.au)

**Jonathan Bothamley**

**(07) 5495 2146**

[mach1caravans@outlook.com](mailto:mach1caravans@outlook.com)











Find us on:  
**facebook.**

2020/2021 QCC Rally Calendar ....

- Oct 07-13 Nanango (Showground).
- Nov 11-17 Goombungee (Showground).
- Dec 01-08 Toogoolawah (Xmas/Showground).
- January Kalbar (Showground).
- February Imbil (Showground).

- March Standown Park.
- April Pine Rivers.
- May Ivory Rock.
- June Samford.
- July Kenilworth.
- August Gin Gin.

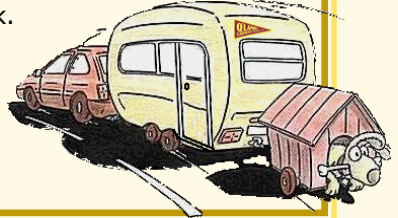

Committee Contacts ...

Position	Incumbent	Phone	Email
President	Paul Brearley	0428 104 989	president@qldcaravanclub.com.au
Secretary	Heather Edney	0411 522 877	secretary@qldcaravanclub.com.au
Editor	Lance Haslewood	0414 295 888	editor@qldcaravanclub.com.au
Webmaster	Lance Haslewood	0414 295 888	webmaster@qldcaravanclub.com.au

**From the Pittsworth Gallery ....**



President's Picnic, Saturday 12 September 2020



President's Picnic, Saturday 12 September 2020

# Action

Mobile Caravan & Trailer Repairs

- Servicing • Towing • Insurance Work

Mobile: 0419 703 189

## THE AWNING MAN

CARAVAN - RV  
MOTORHOMES

- AWNINGS
- ANNEXES
- ANTI-FLAP KITS
- CURVED RAFTERS
- ACCESSORIES

MOB 0411 139 340

ON-SITE INSTALLATION  
IS OUR SPECIALITY

Servicing Brisbane and its Environs  
The Caravan and RV Specialists

BRINGING COVER TO YOU!



**Brisbane  
camperland**  
Sales | Service | Accessories



Discover Living

RV Accessories Store  
RV Service Centre  
**(07) 3917 5555**

[www.brisbanecamperland.com.au](http://www.brisbanecamperland.com.au)

EZICAF SOLUTIONS

# COFFEE-FOR-ONE GOLD FILTER

Superior coffee brewed on 23 karat gold anywhere, anytime.

**A COFFEE SOLUTION THAT'S SIMPLE, PERMANENT, SUSTAINABLE, WASTE-FREE AND ABOVE ALL, DELICIOUS!**

Perfect for camping, travelling, caravanning, AND the home & work!



Find out more or get yours at [WWW.EZICAFSOLUTIONS.COM.AU](http://WWW.EZICAFSOLUTIONS.COM.AU)  
Use code **QLDCC** for 10% off!

**EZICAF**  
SOLUTIONS

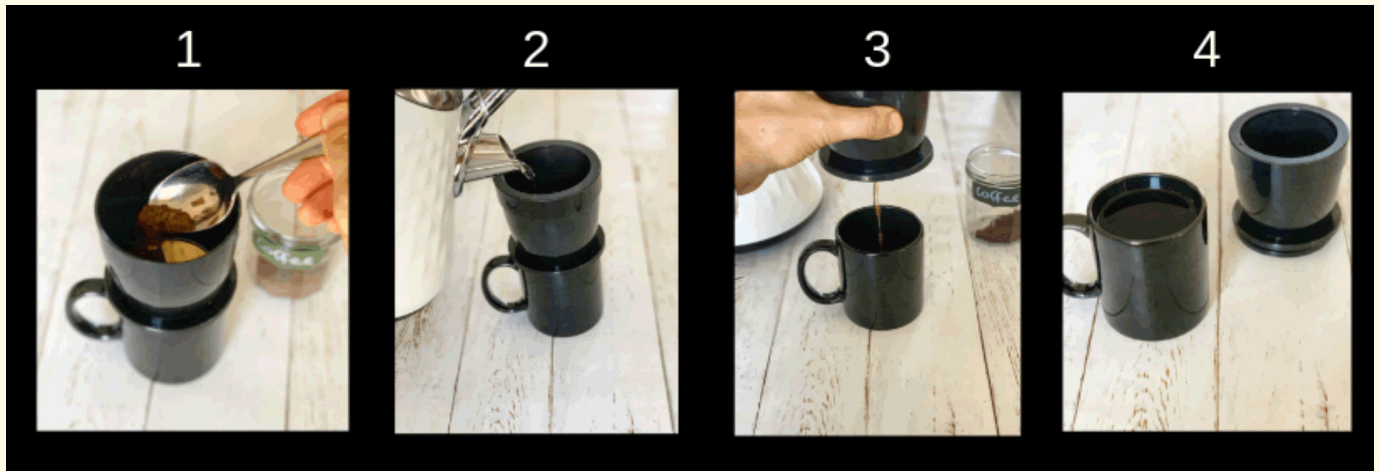

**'Spuds are the go' for the President's Picnic.  
Denise Park, Jan Kirby, Yvonne Robbins and Terry Park ....**



**ATR**  
AUSSIE TRAVELLER

**QUEENSLAND**

11 Oasis Court  
Clontarf QLD 4019

T +61) 7 3284 3284

F +61) 7 3284 5969

E enquiries@aussietraveller.com.au

**VICTORIA**

235A Barry Road  
Campbellfield VIC 3061

T +61) 3 9357 6565

F +61) 3 9357 6515

E info@aussietraveller.com.au

[www.aussietraveller.com.au](http://www.aussietraveller.com.au)



**CARAVAN HEAVEN!**

All your Caravan needs are under one roof  
at Aussie Escape Caravans Brendale, North Brisbane.

**CARAVAN REPAIRS  
AND SERVICE**

Our dedicated team of professional caravan fitters and repair specialists can take on any job no matter how large or small.

**CARAVAN SUPERSTORE**

In Caravan Heaven there is a Superstore full of everything you need.

**Please call us  
on 3205 7738**

we would be happy to provide an obligation free quote.

**CARAVAN SALES**

We sell a range of pre owned and pre loved Caravans. Our friendly and experienced staff can advise you on what Caravan would suit your needs and lifestyle.

Opening hours  
Mon - Fri: 7:30am - 4:30pm  
Sat: 7:30am - 11:30am



40 South Pine Rd Brendale. Look for the windmill!

[www.aussieescapecaravans.com.au](http://www.aussieescapecaravans.com.au)



**FREEZE TEC**

**MARINE / CARAVAN REFRIGERATION & AIRCONDITIONING**

**CARAVAN REPAIRS**

☎ 07 3286 3522    📍 9 Grant Street, Cleveland QLD 4163



**Trusted globally in Supplying and Servicing Marine & Recreational Refrigeration and Air Conditioning since 1989.**

Photographs of members may appear in the QCC Wanderer, its website or on its Facebook Group. Should a member not wish for this to occur, then the member should inform, in writing, the Secretary and the photographer. Whilst all care will be taken to comply with a member's request, no guarantee may be given that his/her photograph will not appear. Any such appearance will be totally unintentional.



President's Picnic - Yvonne Lacey ....



President's Picnic - Ian Farrell ....



Celebrity Heads Host - Kevin Day ....



Celebrity Heads Host - Carol Day ....



Celebrity Heads Participant - Jenny Carroll ....



Mahjong - Desley Hinson, Terry Park, Alf Hinson and Denise Park ....



Birthday outing for Alf Hinson - with Desley Hinson and Steve and Robyn Langley ....



Birthday outing for Alf Hinson - with Heather and Dennis Edney, and Terry and Denise Park ....





Birthday outing for Alf Hinson - Bob and Marilyn Tebbit with Paul and Di Brearley.



QCC's 71st Anniversary Celebratory Cake (It's a Jeep!!) ....



Sewing ladies - Denise Park, Tina Briese, Yvonne Robbins and Robyn Langley .....



Sewing ladies - Jenny Carrol and Margaret Hiller ....



Birthday Greetings - Jan Kirby, Keith McCallum, Jenni McGowan, Bob Rutherford and Alf Hinson ....



Anniversaries - Wendy & Barry Gibson, Gail & Barry Lander, Pat & Greg Mander, Carmel & Beris Abraham, Ann & Bill Dobe ..



Sewing Class (Mesh Pouch) - ?, ?, Pat Mander, Yvonne Robbins, Denise Park, Desley Hinson, Di Brearley, Gwen Egen .....



Adrian Savage delighted to be given a pair of braces with which to keep his duds up. He forgot to bring his belt to the rally!!



## PET POLICY

QUEENSLAND CARAVAN CLUB INC.

*'Fellowship on Wheels'*

### Our Pet Policy ....

This Policy applies to all members, visitors, and guests whilst at a rally site and for the entire duration of the rally, i.e., upon arrival on site and until departure. This Policy is in conjunction with any other pet policy imposed by the venue at which our rally is being held.

It must be remembered that although many of us enjoy pets, not all club members are pet lovers. However, if we abide by a few simple rules, there is no reason why members and visitors cannot all be happy and have a harmonious rally relationship and environment. Please refer to QCC By-Law No. 19 for further details.



It is important to be aware that:

- Pet owners/carers are responsible for keeping their pets quiet at all times.
- Barking dogs may be disturbing to others, and therefore, shall not be tolerated.
- Pets must be restrained and kept within the confines of the owner/carer's caravan/motorhome annex.
- Pets (dogs and cats) are always to be kept on a short leash or other type of restraint.
- When walking a pet, it must be on a short leash or other type of restraint and be in the hands of a responsible adult.
- A pet must not be off its leash anywhere on the rally site. The only exception being if a specific area designated for this purpose is provided by the venue.



Pets are not permitted in the following areas:

- Where food is eaten, prepared and/or served.
- Toilet/shower facilities.
- The hall or meeting area.
- Happy hour. The only exception being where happy hour is held under a member's caravan awning and it is at the discretion of the caravan owner as to whether a pet is permitted.
- Pet owners/carers must clean-up any mess their pet makes.

If a member is attending a rally with a pet, the rally marshal is to be advised on arrival.



IF WE ALL EMPLOY A LITTLE BIT OF CO-OPERATION, CONSIDERATION AND COMMON SENSE, OUR MEMBERS WILL BE HAPPY NEIGHBOURS.



# QCC CORONAVIRUS (COVID-19) DECLARATION



**Rally Venue: Nanango Showgrounds 07-13 October 2020**

**Disclaimer:** In the interest of protecting the health and wellbeing of QCC members and visitors, QCC is required to ask its members questions in relation to their travel and health activities; as of day, entering the rally venue. This information is being collected for the purpose of contact-tracing in the event of positive COVID-19 diagnosis involving this rally, as per the Queensland Chief Health Officer’s Restrictions on Businesses, Activities and Undertakings Direction, (No. 4), or its successor. Personal information will be stored securely and destroyed after 56 days.

Surname/s:		Given Name/s:	
Street:		Town:	Post Code:
Phone 1:		Phone 2:	
Email:			

1. Have I/we:

- Returned from overseas in the past 14 days. Yes  No
- Been required to be in self isolation or self-quarantine. Yes  No
- Been previously diagnosed with COVID-19. Yes  No
- To the best of my/our knowledge, been in close contact with a person who has a reported or suspected case of COVID-19 in the past 14 days. Yes  No
- Been in a COVID-19 hotspot (as defined by the Queensland Chief Health Officer) in the past 14 days. Yes  No
- Had or have/had a fever, cough, sore throat, shortness of breath or other cold/flu-like symptoms in the past 72 hours or are otherwise unwell. Yes  No

2. If you have answered YES to any of these questions, you may be referred to the local health authority.

3. Please provide details of all locations visited and accommodation details for the past 14 days.

**Note:** This information is for contact-tracing purposes only, should it be required and maybe shared with police or the Department of Health if requested.

<u>LOCATION NAME and ADDRESS</u>	<u>DATES STAYED</u>	<u>TIME IN</u>	<u>TIME OUT</u>

I/We agree to comply with venue rules and all Government directives, including, but not limited to, social distancing measures and good hygiene practices. I declare that the answers I have provided above are true and accurate for myself and all the listed parties who are residing with me.

Signature: \_\_\_\_\_ Date: \_\_\_\_\_